



Dear business partners and clients!

In order to correspond to our clients' demands, alternatively we are pleased to offer renewed second hand machines, equipment and spare parts too.
Don't hesitate to contact us, even if you are looking for special purpose machines.

New arrivals:

1 pc. complete loading silo plant – previously used for pellets also appropriate for soy-, rape- or sunflower wholemeal

Erection of the plant in 2008 – rarely used, until 2012 in operation

Consisting of:

- reception with bucket-elevator (not incl. belt conveyor)
- storage in 5 pcs. galvanized MULTIGON silo cells à 400 m³ with smooth walls each with dimensions: 5 x 5 m length x width, total volume: 2.000 m³
Due to sloped edges perfectly suitable for non-freeflowing bulk materials.
- Silo-discharge with OSZILLOMAT-system particularly appropriate for pellets and groats
- truck-loading directly form the silos including scales
- complete static calculation available accord. to EU-standards

In case of purchase the complete plant will be disassembled by the previous supplier of the plant. The costs thereof have to be agreed separately.
The previous supplier also offers the assembling works for the erection of the plant on the site of the buyer. Accord. to the following pictures.





view without cladding



„Multigon“ silos with smooth walls

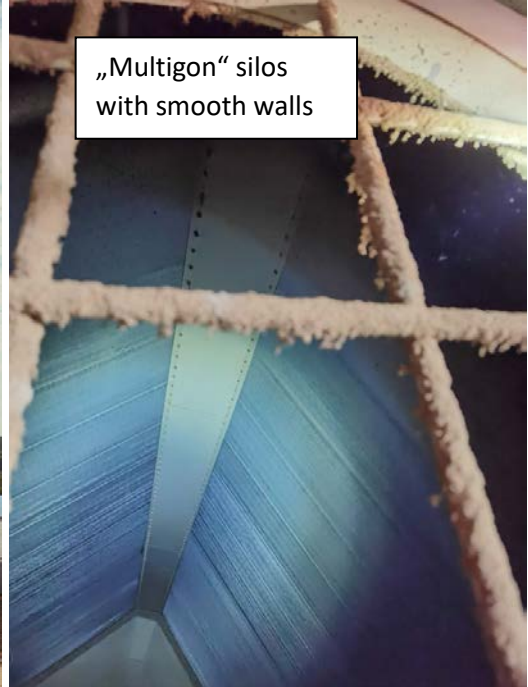

„Multigon“ silos



sample photo for demonstration purpose only





Oszillomat: Special silo-discharge-system



Advantages of the Oszillomat:

- troublefree mass flow
- efficient and constant dosing
- appropriate for materials sensitive to breakage
- safe start of discharge even if bottom pressure is high
- discharge performance: approx. 600 m³/h
- hydraulic drive which requires only low drive power



elevator buckets hardly show any wear



SICON sampler in front of elevator-inlet



elevator head + carrying on screw conveyor

Each silo is equipped with:
-dust filter
-temperature measurement
-level sensors

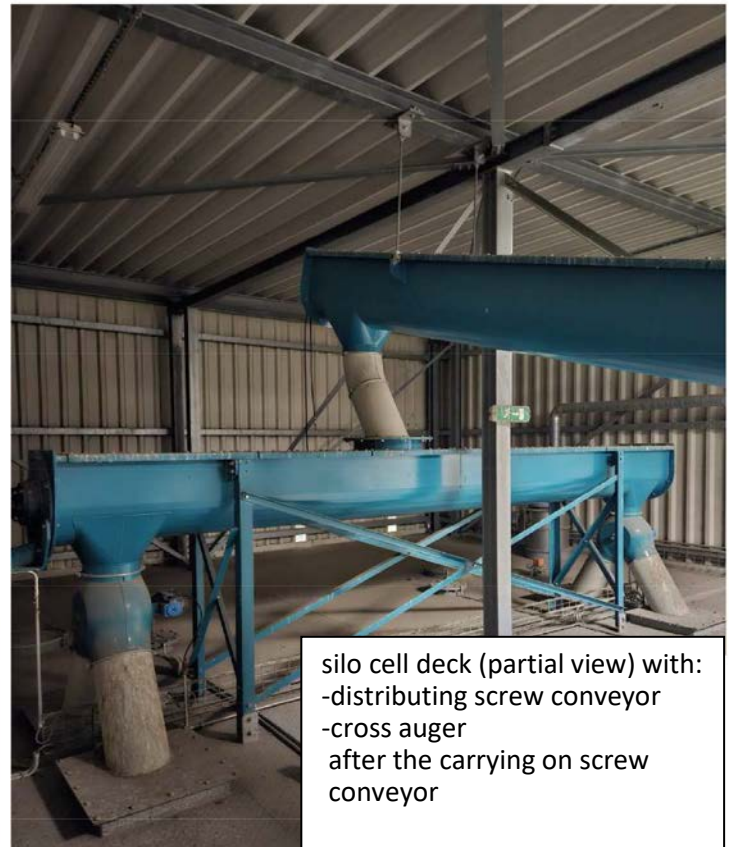

silos cell deck (partial view) with:
-distributing screw conveyor
-cross auger
after the carrying on screw conveyor



partial side view of silos
elevator / shaft



staircase and silo sidewalls

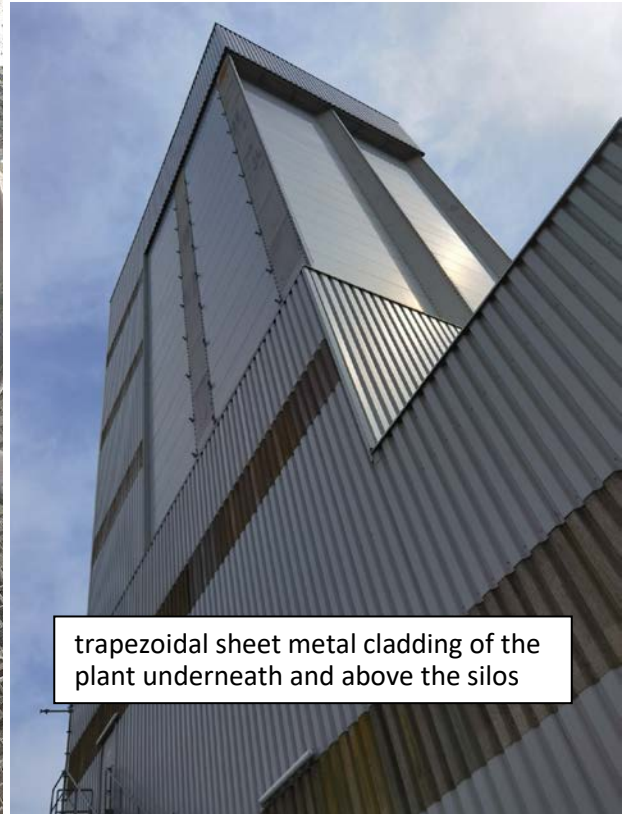

trapezoidal sheet metal cladding of the plant underneath and above the silos



The complete steel construction is bolted and can easily be disassembled and afterwards assembled again!



5 truck-loading points below the silos



main control system of the silo plant



additional control plant on the silo deck

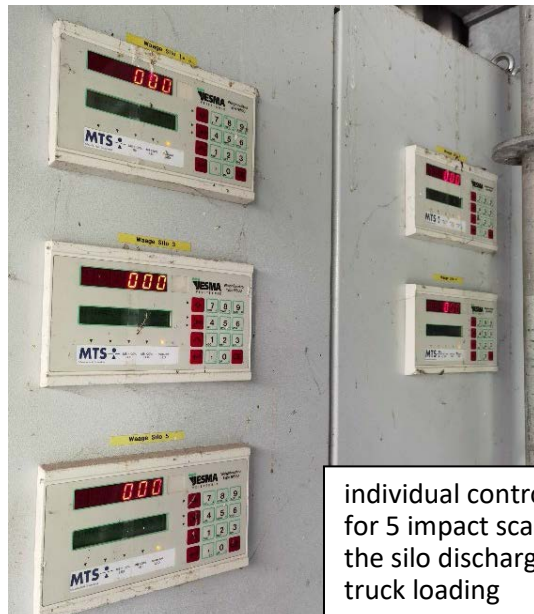

individual controls for 5 impact scales below the silo discharges before truck loading

- Further execution:
- individual control of the silo discharge
 - service sockets on top of the silos
 - fire extinguishing system (from grade to top of silo-level)

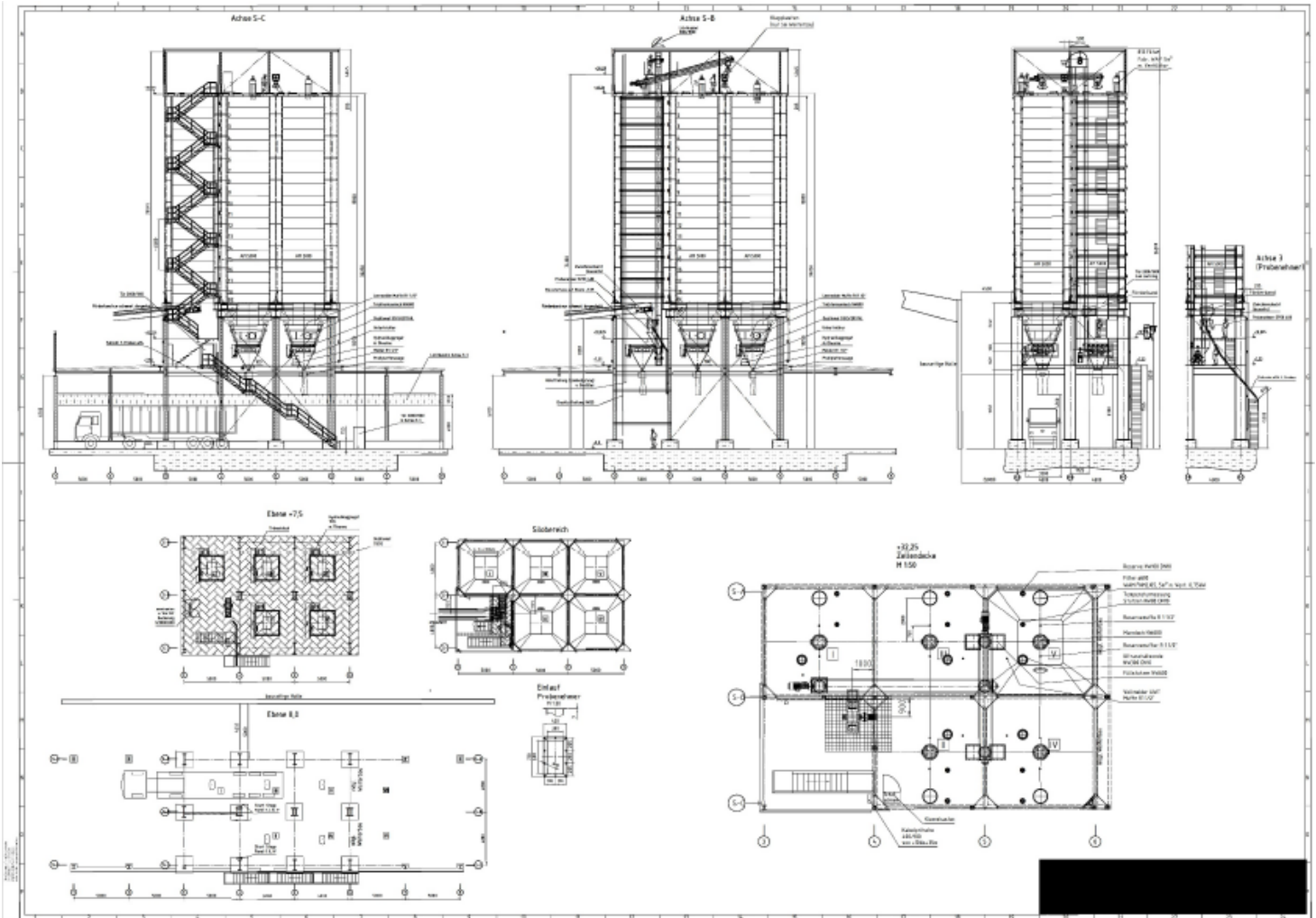

Location: Austria
The plant is subject to prior sale!
Price on request!

Best regards,
HDT GmbH